



Lancasters
Property South East



14 Beckenshaw Gardens, Banstead, Surrey, SM7 3NB
£400,000



Lancasters
Property South East



14 Beckenshaw Gardens, Banstead, Surrey, SM7 3NB

£400,000

MUST BE SEEN!! Two bedroom semi-detached bungalow. Its superbly located at the end of a quiet cul-de-sac with the benefit of being within close proximity to the local shops in both Woodmansterne and Banstead Village. The property has been extended over the years offering huge flexibility with its current layout overlooking the large garden to the side and rear. This home would benefit from modernisation allowing its new owners a very generously proportioned home in a lovely setting.

Description



Situation



null
Council Tax Band:
Available:

Floor Plans

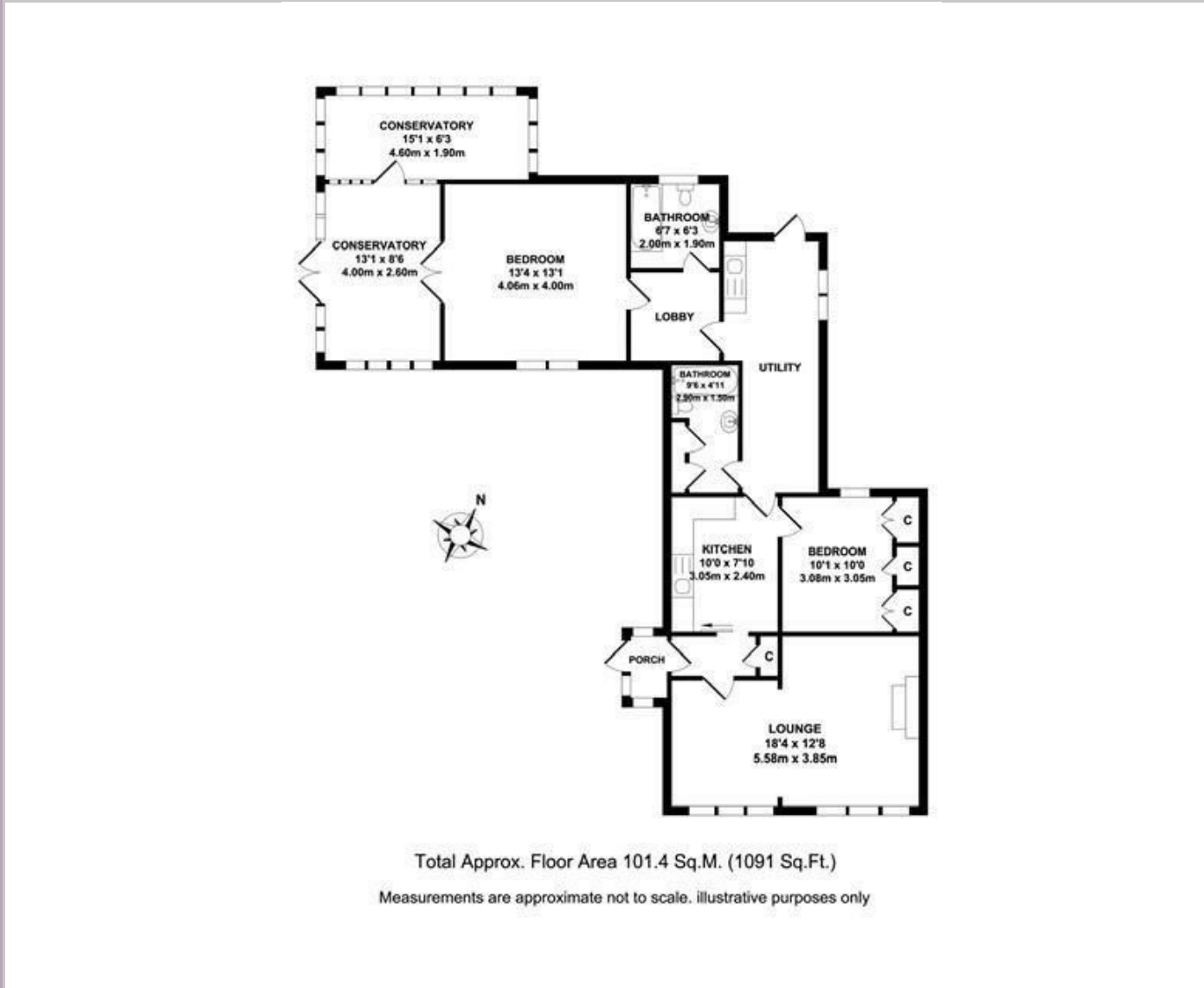

Area Map

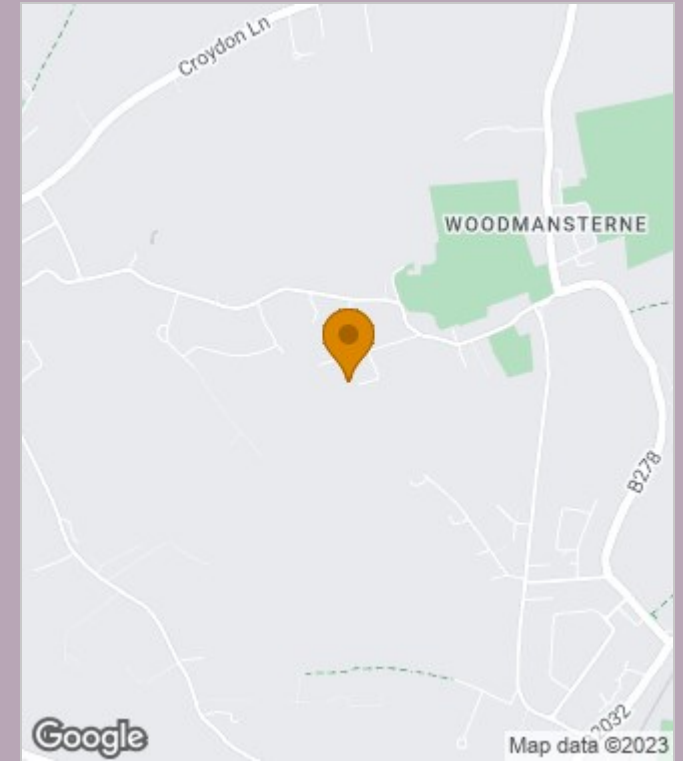

Energy Performance Graph

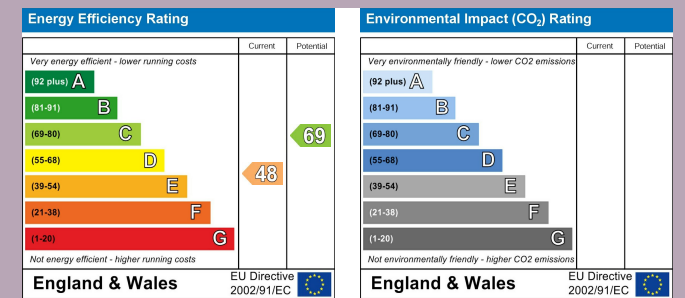

These particulars, whilst believed to be accurate are set out as a general outline only for guidance and do not constitute any part of an offer or contract. Intending purchasers should not rely on them as statements of representation of fact, but must satisfy themselves by inspection or otherwise as to their accuracy. No person in this firm's employment has the authority to make or give any representation or warranty in respect of the property.